

# ASSEMBLY INSTRUCTIONS

## 20" SHELVING UNITS

NOTE: Hand tighten all nuts and bolts until unit is complete. Tightening with a wrench as the unit is built may cause complications. Take caution when using metal tools to avoid damage to the painted surfaces of your unit. Before assembling your unit make sure to UNWRAP ALL COMPONENTS and verify you have all required parts for assembly. Check the parts reference below to identify parts. NOTE: Hardware may be inverted so that the cap nuts go to the bottom at time of assembly for a cleaner look.

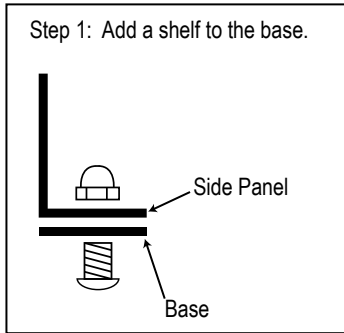

1. To attach a side panel to the base, insert a **SHORT** bolt through the bottom of the base and fasten using a cap nut on the top of the hole.

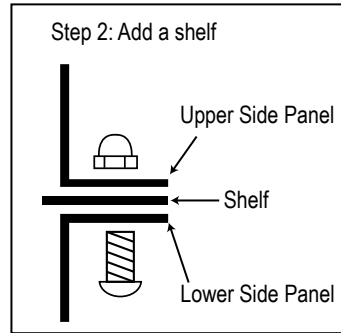

2. Insert a long bolt through the bottom of the hole on the lower shelf side panel, through the shelf hole and into the hole of the upper shelf side panel. Repeat for each additional shelf.

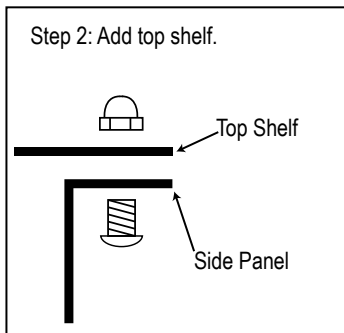

3. Set the last shelf/top in place on the side panel and insert a short bolt through the bottom and secure from top with acorn nut. You may now go back and tighten all hardware with included wrench.

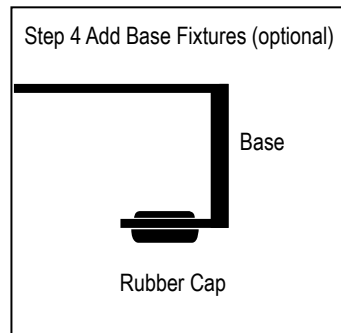

4. Install rubber caps in the holes on the base flange if desired. Optional casters could be installed in these holes as well. If you did not order casters, but would like to add them to your unit, visit [www.boltz.com](http://www.boltz.com) to order them today.

SIDE VIEW

FRONT VIEW

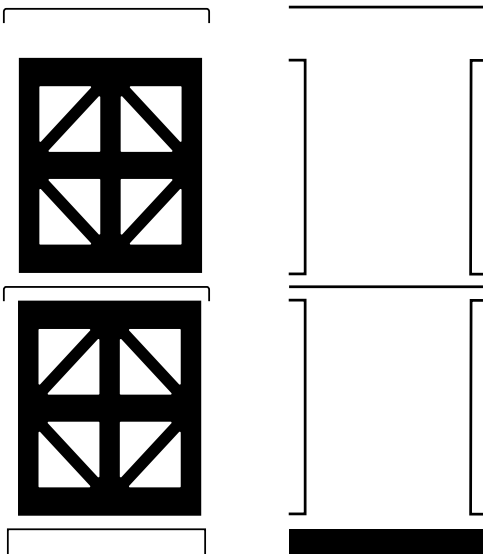

## PARTS REFERENCE

Note: Parts are not to scale. Quantities may vary depending on product. Extra parts are normal.



SIDE PANEL



BASE/SHELF



SHORT BOLT



LONG BOLT



CAP NUT



RUBBER CAP

If you have any questions, please call us toll-free at 877.804.7650 (M-F 8:30am-5:30pm PT) or email us at [customerservice@boltz.com](mailto:customerservice@boltz.com). Visit us online at [www.boltz.com](http://www.boltz.com).